

Insulated pin terminals KII type

FEATURES & BENEFITS



-



-



-



-

MECHANICAL DATA

Insulated polyamide 6.6

Material Cu

Surface tin-plated

Working temperature [°C] -30 ÷ +95

CERTIFICATES & STANDARDS

Release DIN 46231

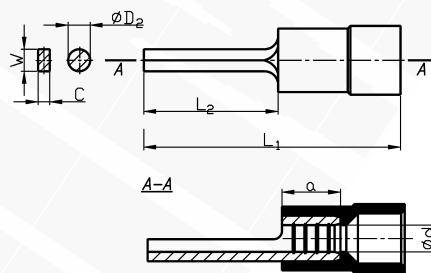

Type	Index Ergom	Cross section [mm ²]	Insulation color	DIN	d	L ₁	L ₂	a	D ₂	C	W	Available packages [szt.]	Weights [kg]
KII 0,5-8 (100 SZT./PCS)	E09KO-02040100101	0,1+0,5	yellow	-	1,0	18,0	8,0	-	1,4	-	-	100	0.03
KII 1-10 (100 SZT./PCS)	E09KO-02040100200	0,75+1,0	red	-	1,6	21,0	10,0	4,8	1,9	-	-	100	0.08
KII 1-12 (100 SZT./PCS)	E09KO-02040100300			√		23,0	12,0						
KII 1-16 (100 SZT./PCS)	E09KO-02040100400			-		27,0	16,0						
KII 2,5-10 (100 SZT./PCS)	E09KO-02040100500	1,5+2,5	blue	-	2,3	21,0	10,0	4,8	1,9	-	-	100	0.09
KII 2,5-12 (100 SZT./PCS)	E09KO-02040100600			√		23,0	12,0						
KII 2,5-16 (100 SZT./PCS)	E09KO-02040100800			-		27,0	16,0						
KII 6-14 (100 SZT./PCS)	E09KO-02040100900	4+6	yellow	√	3,6	27,0	14,0	6,0	2,7	-	-	100	0.17
KII 10-12 (100 SZT./PCS)	E09KO-02040101000	10	red	-	4,5	34,0	12,0	8,0	-	2,4	4,5	100	0.34
KII 10-12 (10 SZT./PCS)	E09KO-02040101002											10	0.034
KII 16-13 (100 SZT./PCS)	E09KO-02040101100	16	blue	-	5,8	41,0	13,0	10,0	-	2,6	5,5	100	0.51
KII 16-13 (10 SZT./PCS)	E09KO-02040101102											10	0.051
KII 25-15 (100 SZT./PCS)	E09KO-02040101200	25	yellow	-	7,0	44,0	15,0	13,5	-	2,6	6,8	100	0.88
KII 25-15 (10 SZT./PCS)	E09KO-02040101202											10	0.088
KII 35-20 (100 SZT./PCS)	E09KO-02040101300	35	red	-	8,4	52,5	20,0	16,0	-	3,2	8,0	100	1
KII 35-20 (10 SZT./PCS)	E09KO-02040101302											10	0.1
KII 50-20 (100 SZT./PCS)	E09KO-02040101400	50	blue	-	9,6	61,0	20,0	19,0	-	3,8	9,5	100	1.25
KII 50-20 (10 SZT./PCS)	E09KO-02040101402											10	0.125
KII 70-23 (100 SZT./PCS)	E09KO-02040101500	70	yellow	-	11,4	71,0	23,5	24,0	-	4,2	11,0	100	1.95
KII 70-23 (10 SZT./PCS)	E09KO-02040101502											10	0.195
KII 95-23,5 (100 SZT./PCS)	E09KO-02040101600	95	red	-	13,5	71,0	23,5	24,0	-	5,0	12,5	100	2.8
KII 95-23,5 (10 SZT./PCS)	E09KO-02040101602											10	0.28