

logistics details

Product title:	Pin terminals KI type
Type:	KI 50-20 (50 SZT./PCS)

Weight netto: ~ 0,925 kg

Certificates

Design	DIN 46230 – concerns only the tubular part of terminal
--------	---

mechanical details

Material	Cu
Surface	tin-plated
DIN	–

Sections

Cross section [mm ²]	50
----------------------------------	-----------

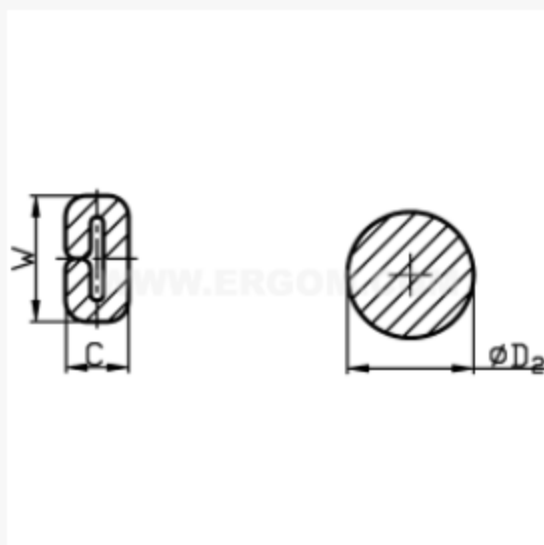
**Sizes**

d	9,6
D ₁	13,6
D ₂	–
L ₁	45
L ₂	20
a	19
C	3,8
W	9,5