

**logistics details**

Product title:	<b>Pin terminals KI type</b>
Type:	<b>KI 25-15 (100 SZT./PCS)</b>

Weight netto: ~ 0,546 kg

**Certificates**

Design	<b>DIN 46230 – concerns only the tubular part of terminal</b>
--------	---

**mechanical details**

Material	<b>Cu</b>
Surface	<b>tin-plated</b>
DIN	–

**Sections**

Cross section [mm <sup>2</sup> ]	<b>25</b>
----------------------------------	-----------

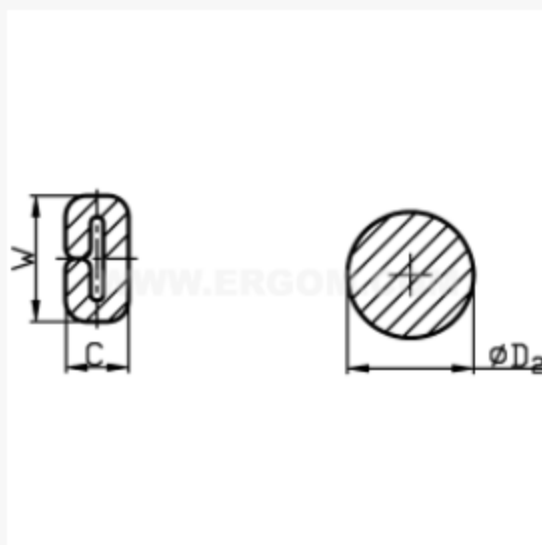
**Sizes**

d	<b>7</b>
D <sub>1</sub>	<b>9,5</b>
D <sub>2</sub>	–
L <sub>1</sub>	<b>33,5</b>
L <sub>2</sub>	<b>15</b>
a	<b>13,5</b>
C	<b>2,6</b>
W	<b>6,8</b>