



Combine the RF Pilot remote controller with the RF Touch control unit for maximum utilization of the RF Control system features.

Technical parameters	RF Pilot/W	RF Pilot/A
Display		
Type:	color OLED	
Resolution:	128 x 128 pixels	
Side ratio:	1:1	
Visible surface:	26 x 26 mm	
Backlighting:	self-illuminating text	
Diagonal:	1,5"	
Control:	direction button, control buttons	
Power supply		
Power supply:	2 x 1.5 V AAA batteries / R03	
Battery life:	approx. 3 years, according to the frequency of use and battery type	
Control		
Range in free space:	up to 200 m	
Frequency:	866 MHz, 868 MHz, 916 MHz, 922 MHz	
Other data		
Operating temperature:	0 to +55 °C	
Storage temperature:	-20 to +70 °C	
Color design:	white	anthracite
Protection:	IP20	
Operating position:	any	
Dimensions:	130 x 41 x 18 mm	
Weight:	61 g	
Related standards:	EN 60730-1	

- The RF Pilot remote control is a central controller for switching electrical appliances and equipment, dimming lights, controlling blinds, etc.
- When pressing the button, it sends a set signal (ON / OFF, dimming, time switching OFF / ON, blinds up / down).
- Option of setting light scenes, where with a single press, you can control up to 10 units at once.
- The Favorites mode lets you preset the most frequently used devices on the home screen.
- Option of grouping dimmers (RFDA-73M/RGB), where you can place up to 10 units under a single control panel = control of over 100 m of colored LED strip.
- Designed in white and anthracite with color OLED display.
- Display of room temperature, battery status, date and time directly on display.
- Bidirectional communication, transmits and receives commands and displays the status of units.
- Thanks to the function of measuring the signal between the controller and unit, you can use it for testing the range and signal quality.
- It is possible to combine up to 40 units of iNELS RF Control (you can gradually expand the installation from 1 unit).
- Battery power (1.5 V 2x AAA - included in supply) with battery life of around 3 years based on frequency of use and type of batteries.
- Range up to 200 m (in open space), if the signal is insufficient between the controller and unit, use the signal repeater RFRP-20.
- Communication frequency with bidirectional protocol iNELS RF Control.

Device description

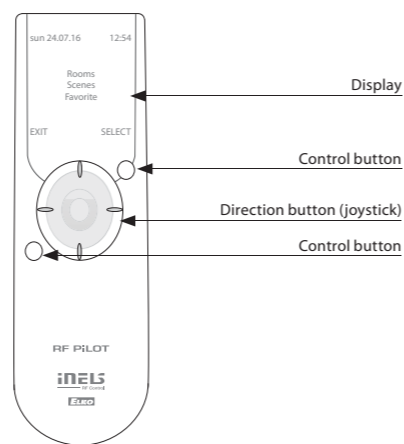

Display description

Color OLED display

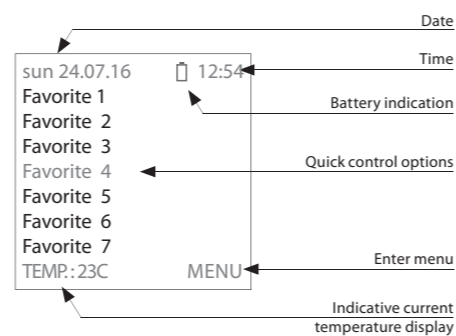

RF Pilot

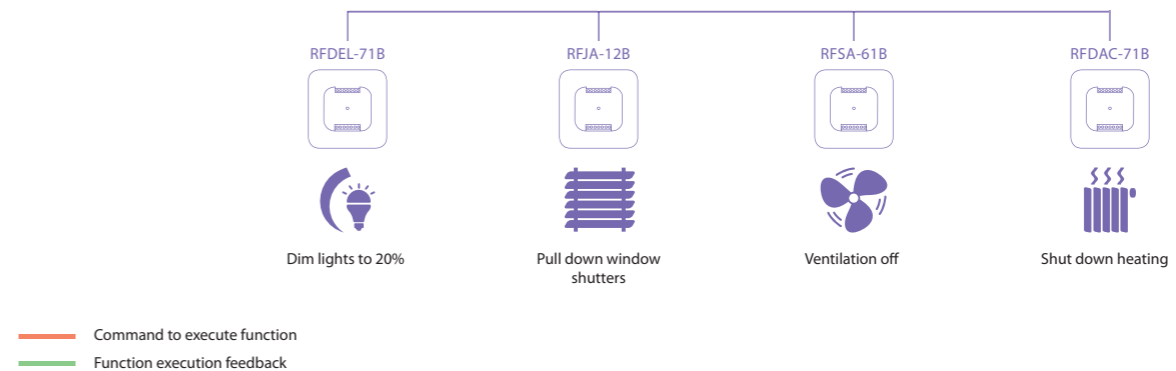
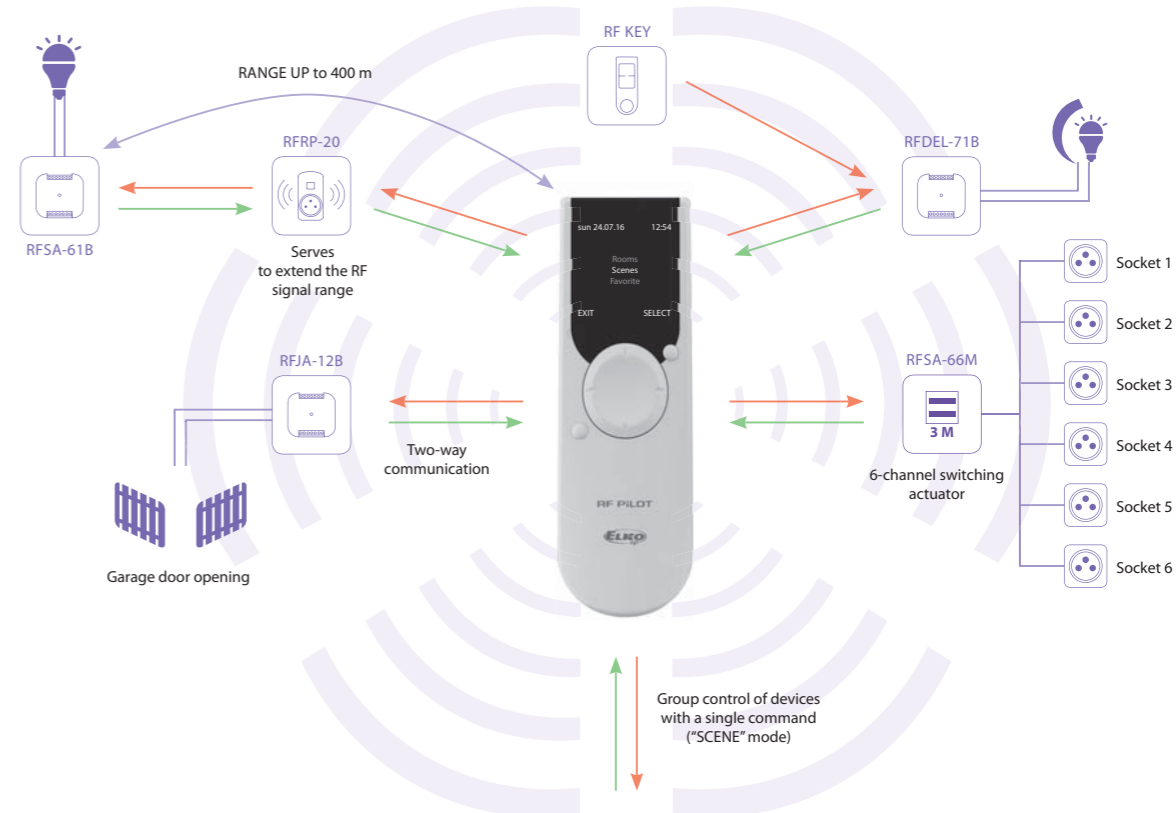
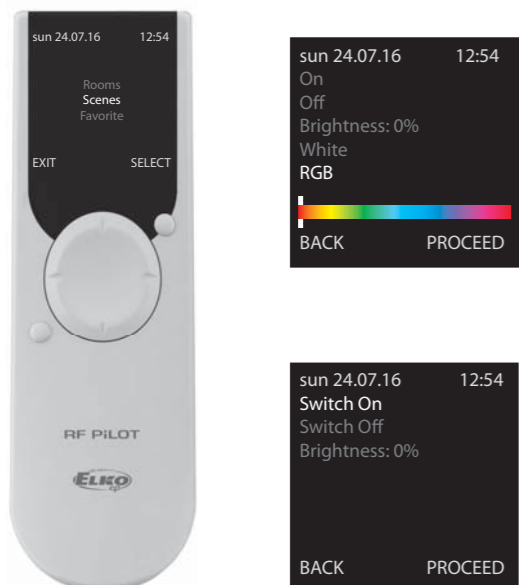

SCENES

- serves to control actuators as a group with a single touch
- possibility to set up scenes; on activation, for example, window shutters are pulled down and the light will adjust to the required brightness

WINDOW SHUTTERS

- controlling window shutters, blinds, garage door, etc.
- window shutters are controlled separately or as a group
- the window shutter receivers are powered by either 230 V or 24 V DC (shutters between windows)

FAVOURITE

- serves to select the most frequently used devices
- on display activation, the "Favourite" menu pops up automatically to provide you with a quick access to controlling devices

SWITCHING

- this function serves to switch on/off lights, sockets, electrical appliances and devices
- intuitive control thanks to customized name options
- switching actuator function selections: switch on/off, impulse relay, button, delayed ON/OFF (time of delay from 2 seconds to 60 minutes)

DIMMING

- the regulation of light intensity (light bulbs, LED strips, halogen lights with electrical or coil transformer, fluorescent tubes with dimmable ballast 1-10 V)
- customizable names of individual dimmed circuits (such as "lights" or "living room")
- "sunrise/sunset" imitation - light gradually goes on or off during the preset period between 2 seconds and 30 minutes