

# Pressacavi IP68 passo METRICO

## Cable gland IP68 metric thread



Grado di protezione IP68 5 bar  
 Materiale pressacavo Poliammide  
 Guarnizione in Neoprene (BE=EPDM)  
 Temperatura d'esercizio -30 +80°C  
 Resistenza al calore +150°C  
 Colore Grigio RAL7035 o Nero RAL9005

Protection degree IP68 5 bar  
 Cable gland material Polyamide  
 Sealing of Neoprene (BE=EPDM)  
 Working Temperature -30 +80°C  
 Heat resistance +150°C  
 Colour Grey RAL7035 or Black RAL9005

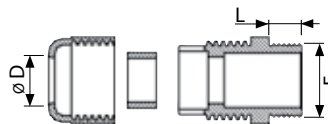

				Filettatura esterna External thread (F)	Campo serraggio Clamping range (ØD) mm	Lunghezza filetto Thread length (L) mm		
							Corpo Body mm	Testa Head mm
<b>350M1201</b>	<b>350M1203</b>	<b>124M1201B</b>	<b>124M12EX03</b>	M12	3 - 6,5	6 (Ex 8)	15	15
<b>350M1601</b>	<b>350M1603</b>	<b>124M1601B</b>	<b>124M16EX03</b>	M16	4 - 8 (Ex 5- 10)	8 (Ex 10)	19 (Ex 22)	19 (Ex 22)
<b>350M2001</b>	<b>350M2003</b>	<b>124M2001B</b>	<b>124M20EX03</b>	M20	6 - 12	10	24	24
<b>350M2501</b>	<b>350M2503</b>	<b>124M2501B</b>	<b>124M25EX03</b>	M25	11 - 17 (Ex 13 - 18)	8 (Ex 10)	29 (Ex 33)	29 (Ex 33)
<b>350M3201</b>	<b>350M3203</b>	<b>124M3201B</b>	<b>124M32EX03</b>	M32	15 - 21 (Ex 18 - 25)	10 (Ex 18)	36 (Ex 42)	36 (Ex 42)
<b>350M4001</b>	<b>350M4003</b>	<b>124M4001B</b>	<b>124M40EX03</b>	M40	19 - 28 (Ex 22 - 32)	10 (Ex 18)	46 (Ex 53)	46 (Ex 53)
<b>350M5001</b>	<b>350M5003</b>			M50	30 - 38	18	60	60
<b>350M6301</b>	<b>350M6303</b>			M63	34 - 44	18	65	65



I pressacavi 124P..01B sono forniti con un tappo di protezione

The cable glands 124P..01B are supplied with protection cap



I pressacavi 124M..EX03 sono ideati per ambienti con rischio di esplosione EEx e II livello "e"

The cable glands 124M..EX03 are suitable for explosive areas EEx and II with safety level "e"

# Pressacavi IP68 passo PG Cable gland IP68 Pg thread



Grado di protezione IP68 5 bar  
Materiale pressacavo Poliammide  
Guarnizione in Neoprene (BE=EPDM)  
Temperatura d'esercizio -30 +80°C  
Resistenza al calore +150°C  
Colore Grigio RAL7035

Protection degree IP68 5 bar  
Cable gland material Polyamide  
Sealing of Neoprene (BE=EPDM)  
Working Temperature -30 +80°C  
Heat resistance +150°C  
Colour Grey RAL7035

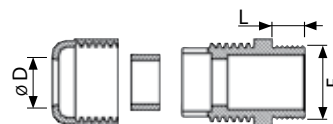

Filettatura esterna External thread (F)	Campo serraggio Clamping range (ØD) mm	Lunghezza filetto Thread length (L) mm	🔧				
			Corpo Body mm	Testa Head mm			
<b>350P0701</b>	<b>124P0701B</b>	<b>124P0701BE</b>	Pg 7	3 - 6,5	8	15	15
<b>350P0901</b>	<b>124P0901B</b>	<b>124P0901BE</b>	Pg 9	4 - 8	8	19	19
<b>350P1101</b>	<b>124P1101B</b>	<b>124P1101BE</b>	Pg 11	5 - 10	8	22	22
<b>350P1301</b>	<b>124P1301B</b>	<b>124P1301BE</b>	Pg 13,5	6 - 12	9	24	24
<b>350P1601</b>	<b>124P1601B</b>	<b>124P1601BE</b>	Pg 16	10 - 14	10	27	27
<b>350P2101</b>	<b>124P2101B</b>	<b>124P2101BE</b>	Pg 21	13 - 18	11	33	33
<b>350P2901</b>	<b>124P2901B</b>	<b>124P2901BE</b>	Pg 29	18 - 25	11	42	42
<b>350P3601</b>			Pg 36	22 - 32	13	53	53
<b>350P4201</b>			Pg 42	30 - 38	13	60	60
<b>350P4801</b>			Pg 48	34 - 44	14	65	65



I pressacavi con codice finale B o BE (passo PG e Metrico) sono forniti con controdado e imballati in sacchetto BLISTER

The cable glands with final code B or BE (Pg and Metric thread) are supplied with locknut and packaging with BLISTER bag



Per i pressacavi, con packaging BLISTER, è disponibile l'espositore da banco

For the cable glands with packaging BLISTER, is available the bench displayer

Articolo - Item **EXPOBLISTER**

# Pressacavi IP68 con fissaggio rapido

## Cable gland IP68 with quick locking



Grado di protezione IP68 5 bar  
 Materiale pressacavo Poliammide 6  
 Guarnizione in Cloroprene (CR)  
 Temperatura d'esercizio -20 +100°C  
 Resistenza al calore +150°C  
 Colore Grigio RAL7035

Protection degree IP68 5 bar  
 Cable gland material Polyamide 6  
 Sealing of Chloroprene (CR)  
 Working Temperature -20 +100°C  
 Heat resistance +150°C  
 Colour Grey RAL7035

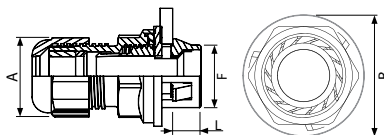

	Campo serraggio	Filettatura esterna	Lunghezza aggancio		
	Clamping range	External thread	Connection length	Base Base	Testa Head
	mm	F mm	L mm	B mm	A mm
<b>124M1601C</b>	Ø 5 - 10	M16	9	22	22
<b>124M2001C</b>	Ø 6 - 12	M20	9	24	24



Inserire il pressacavo nel foro. Il pressacavo è fornito con guarnizione in gomma per garantire l'IP68

Insert the cable gland in the hole. The cable gland is supplied with rubber seal to guarantee the IP68



Premere il pressacavo fino allo scatto. Questo sistema di fissaggio rapido riduce notevolmente il tempo d'installazione

Push the cable gland until the click. This new quick fixing system reduce very much the application time



Girare il pressacavo fino al suo completo bloccaggio

Lock by turning the cable gland

# Pressacavi IP68 con proteggicavo Cable gland IP68 with cable protection



Grado di protezione IP68 5 bar  
Materiale pressacavo Poliammide  
Guarnizione in Neoprene  
Temperatura d'esercizio -30 +80°C  
Resistenza al calore +150°C  
Colore Nero RAL9005

Protection degree IP68 5 bar  
Cable gland material Polyamide  
Sealing of Neoprene  
Working Temperature -30 +80°C  
Heat resistance +150°C  
Colour Black RAL9005

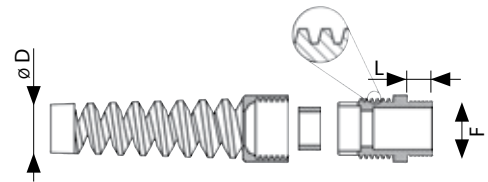

	Filettatura esterna External thread (F)	Campo serraggio Clamping range (ØD) mm	Lunghezza filetto Thread length (L) mm		
				Corpo Body mm	Testa Head mm
<b>124SM1203</b>	M12	3 - 6,5	8	15	15
<b>124SM1603</b>	M16	5 - 10	10	22	22
<b>124SM2003</b>	M20	10 - 14	10	27	27
<b>124SM2503</b>	M25	13 - 18	10	33	33

<b>124SP0703</b>	Pg 7	3 - 6,5	8	15	15
<b>124SP0903</b>	Pg 9	4 - 8	8	19	19
<b>124SP1103</b>	Pg 11	5 - 10	8	22	22
<b>124SP1303</b>	Pg 13,5	6 - 12	9	24	24
<b>124SP1603</b>	Pg 16	10 - 14	10	27	27
<b>124SP2103</b>	Pg 21	13 - 18	11	33	33

# Controdadi Locknuts



Materiale Poliammide  
 Temperatura d'esercizio -30 +80°C  
 Resistenza al calore +150°C  
 Colore Grigio RAL7035 o Nero RAL9005

Material Polyamide  
 Working Temperature -30 +80°C  
 Heat resistance +150°C  
 Colour Grey RAL7035 or Black RAL9005



Articolo colore Grigio Item Grey colour	Articolo colore Nero Item Black colour	Filettatura esterna External thread	Spessore Thickness mm	 mm
<b>3420M12</b>	<b>3420M1203</b>	M12	5	18
<b>3420M16</b>	<b>3420M1603</b>	M16	5	22
<b>3420M20</b>	<b>3420M2003</b>	M20	6	26
<b>3420M25</b>	<b>3420M2503</b>	M25	6	32
<b>3420M32</b>	<b>3420M3203</b>	M32	7	41
<b>3420M40</b>	<b>3420M4003</b>	M40	7	50
<b>3420M50</b>	<b>3420M5003</b>	M50	8	60
<b>3420M63</b>	<b>3420M6303</b>	M63	8	75

<b>3420P07</b>		Pg 7	5	19
<b>3420P09</b>		Pg 9	5	22
<b>3420P11</b>		Pg 11	5	24
<b>3420P13</b>		Pg 13,5	6	27
<b>3420P16</b>		Pg 16	6	30
<b>3420P21</b>		Pg 21	7	36
<b>3420P29</b>		Pg 29	7	46
<b>3420P36</b>		Pg 36	8	60
<b>3420P42</b>		Pg 42	8	65
<b>3420P48</b>		Pg 48	8	70

# Tappi filettati e guarnizioni

## Screw plugs and sealing rings



Materiale Poliammide  
 Temperatura d'esercizio -30 +80°C  
 Resistenza al calore +150°C  
 Colore Grigio RAL7035



Material Polyamide  
 Working Temperature -30 +80°C  
 Heat resistance +150°C  
 Colour Grey RAL7035

Materiale Gomma Dutral  
 Temperatura d'esercizio -40 +100°C  
 Colore Nero  
 Spessore 1,5 mm



Material Dutral rubber  
 Working Temperature -40 +100°C  
 Colour Black  
 Thickness 1,5 mm

Articolo Item	Filettatura esterna External thread	Lunghezza filetto Thread length mm	Spessore Thickness mm	Testa Head mm
<b>514M12</b>	M12	6	10,5	18
<b>514M16</b>	M16	6	10,5	22
<b>514M20</b>	M20	6	10,5	26
<b>514M25</b>	M25	8	12,5	32
<b>514M32</b>	M32	8	13	41
<b>514M40</b>	M40	8	13,5	50
<b>514M50</b>	M50	10	16	60
<b>514M63</b>	M63	12	16,5	75

<b>514P07</b>	Pg 7	6	8	15
<b>514P09</b>	Pg 9	6	9	19
<b>514P11</b>	Pg 11	6	9	22
<b>514P13</b>	Pg 13,5	6	9,5	25
<b>514P16</b>	Pg 16	6	9,5	27
<b>514P21</b>	Pg 21	8	11	33
<b>514P29</b>	Pg 29	8	12	44
<b>514P36</b>	Pg 36	10	15	55
<b>514P42</b>	Pg 42	10	16	62
<b>514P48</b>	Pg 48	12	18,5	69

Articolo Item	Eterno External Ø mm	Interno Internal Ø mm
<b>986DM12</b>	18	11
<b>986DM16</b>	21	15
<b>986DM20</b>	27	19
<b>986DM25</b>	34	24
<b>986DM32</b>	40	32
<b>986DM40</b>	51	39
<b>986DM50</b>	60	48
<b>986DM63</b>	72	62

<b>986DP07</b>	17	12
<b>986DP09</b>	20	15
<b>986DP11</b>	23	18
<b>986DP13</b>	25	20
<b>986DP16</b>	28	22
<b>986DP21</b>	38	28
<b>986DP29</b>	45	37
<b>986DP36</b>	56	47
<b>986DP42</b>	62	54
<b>986DP48</b>	69	59

# Pressacavi IP68 in ottone nichelato

## Cable gland IP68 nickel plated brass



Grado di protezione IP68 5 bar  
 Materiale Ottone nichelato  
 Guarnizione in NBR  
 Temperatura d'esercizio -40 +100°C  
 Resistenza al calore +150°C  
 Colore Nichelato

Protection degree IP68 5 bar  
 Material Nichel plated brass  
 Sealing of NBR  
 Working Temperature -40 +100°C  
 Heat resistance +150°C  
 Colour Nichel plated

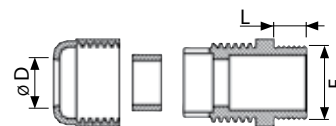

	Filettatura esterna External thread <b>F</b>	Campo serraggio Clamping range <b>Ø D mm</b>	Lunghezza filetto Thread length <b>L mm</b>		
				Corpo Body mm	Testa Head mm
<b>2532M12A</b>	M12	3 - 6,5	6	14	14
<b>2532M16A</b>	M16	4 - 8	7	18	17
<b>2532M20A</b>	M20	6 - 12	8	22	22
<b>2532M25A</b>	M25	10 - 14	8	27	24
<b>2532M32A</b>	M32	13 - 18	9	34	30
<b>2532M40A</b>	M40	18 - 25	9	43	40
<b>2532M50A</b>	M50	22 - 32	9	55	50
<b>2532M63A</b>	M63	34 - 44	14	68	64



	Spessore Thickness mm	
		Dado Locknut mm
<b>420M12</b>	2,8	15
<b>420M16</b>	3	19
<b>420M20</b>	3,5	24
<b>420M25</b>	4	30
<b>420M32</b>	5	36
<b>420M40</b>	5	46
<b>420M50</b>	5	60
<b>420M63</b>	5	70

# Pressacavi IP54 in ottone nichelato

## Cable gland IP54 nickel plated brass



Grado di protezione IP54  
 Materiale Ottone nichelato  
 Guarnizione in NBR  
 Temperatura d'esercizio -40 +100°C  
 Resistenza al calore +150°C  
 Colore Nichelato

Protection degree IP54  
 Material Nichel plated brass  
 Sealing of NBR  
 Working Temperature -40 +100°C  
 Heat resistance +150°C  
 Colour Nichel plated



Filettatura esterna External thread	Campo serraggio Clamping range	Longitud rosca Thread length		
			Corpo Body	Testa Head
F	Ø D mm	L mm	mm	mm

Spessore Thickness		
	Dado Locknut	
mm	mm	

<b>530P07</b>	Pg 7	5 - 7	5,0	14	13
<b>530P09</b>	Pg 9	6 - 8	6,0	17	15
<b>530P11</b>	Pg 11	8 - 10	6,0	20	18
<b>530P13</b>	Pg 13,5	11 - 13	6,5	22	20
<b>530P16</b>	Pg 16	13 - 15	6,5	24	22
<b>530P21</b>	Pg 21	17 - 19	7,0	30	28
<b>530P29</b>	Pg 29	24 - 26	8,0	40	37
<b>530P36</b>	Pg 36	31 - 33	9,0	33	31
<b>530P42</b>	Pg 42	37 - 39	10,0	57	54
<b>530P48</b>	Pg 48	41 - 43	10,0	64	60

<b>420P07</b>	2,8	15
<b>420P09</b>	2,8	18
<b>420P11</b>	3,0	21
<b>420P13</b>	3,0	23
<b>420P16</b>	3,0	26
<b>420P21</b>	3,5	32
<b>420P29</b>	4,0	41
<b>420P36</b>	5,0	51
<b>420P42</b>	5,0	60
<b>420P48</b>	5,5	64